

GLASSVIT

Glass door systems / Glastür-Systeme

Systèmes pour portes en verre / Glasdeursystemen



304
V2A

Ceiling pivot bar for glass door, satin stainless steel
Glastür-Drehgelenk für Deckenmontage, V2A gebürstet
Pivot supérieur, inox brossé
Glasdeur bovendraaischoen, RVS geborsteld

Art.Nr.	glass / Glas / verre / glas
45.0150.000.12	10 - 12 mm

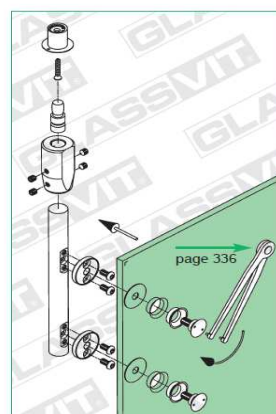
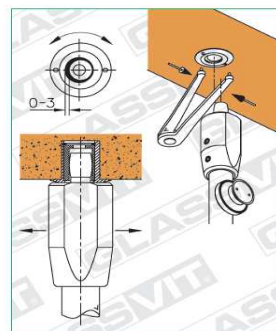
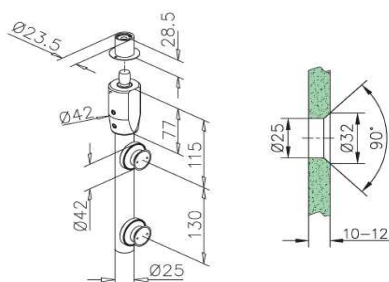

304
V2A

Floor pivot bar for glass door, satin stainless steel
Glastür-Drehgelenk für Bodenmontage, V2A gebürstet
Pivot inférieur avec crapaudine, inox brossé
Glasdeur onderdraaischoen, RVS geborsteld

Art.Nr.	glass / Glas / verre / glas
45.0152.000.12	10 - 12 mm

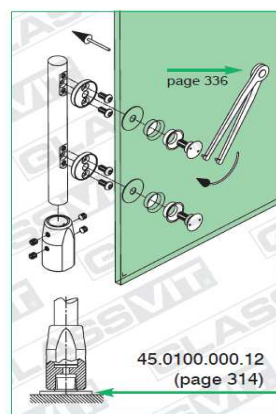
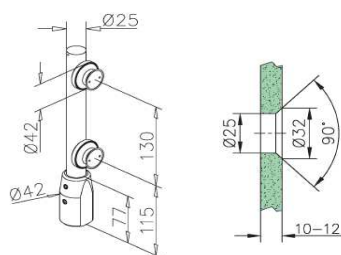

GLASSVIT.

Glass door systems / Glastür-Systeme
Systèmes pour portes en verre / Glasdeursystemen



304
V2A

Transom pivot bar for glass door, glass/glass, satin stainless steel
Glastür-Drehgelenk, Querverbindung Glas/Glas, V2A gebürstet
Pivot supérieur, fixation verre, inox brossé
Glasdeur bovendraaischoen met bovenpaneelbevestiging, RVS geborsteld

Art.Nr.	glass / Glas / verre / glas
45.0154.000.12	10 - 12 mm

