

PH101 Material: SUS304+Walnut Finish: PSS/BSS

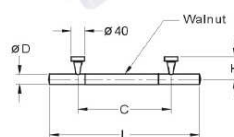

| Item No. | Ø D | L | C | H |
|----------|------|------|------|------|
| PH101A | Ø 25 | 1000 | 800 | 52.5 |
| PH101B | Ø 32 | 1200 | 1000 | 56 |
| PH101C | Ø 38 | 2000 | 1800 | 59 |
| PH101E | Ø 25 | 400 | 210 | 52.5 |

PH102 Material: SUS304 Finish: PSS/BSS/PVD

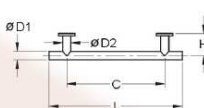

| Item No. | Ø D1 | Ø D2 | L | C | H |
|----------|------|------|------|------|----|
| PH102 | Ø 25 | Ø 22 | 400 | 210 | 60 |
| PH102A | Ø 22 | Ø 19 | 800 | 600 | 55 |
| PH102B | Ø 25 | Ø 22 | 1000 | 800 | 55 |
| PH102C | Ø 32 | Ø 25 | 1200 | 1000 | 60 |
| PH102D | Ø 38 | Ø 32 | 1500 | 1200 | 65 |
| PH102F | Ø 25 | Ø 22 | 350 | 250 | 55 |
| PH102G | Ø 25 | Ø 22 | 720 | 620 | 55 |
| PH102I | Ø 25 | Ø 22 | 400 | 250 | 55 |
| PH102J | Ø 25 | Ø 22 | 800 | 400 | 55 |
| PH102K | Ø 32 | Ø 25 | 500 | 350 | 60 |

PH103 Material: SUS304 Finish: PSS/BSS/PVD

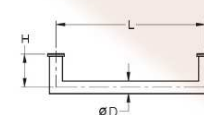

| Item No. | Ø D | L | H |
|----------|------|-----|------|
| PH103A | Ø 25 | 250 | 57.5 |
| PH103B | Ø 25 | 300 | 57.5 |
| PH103C | Ø 25 | 350 | 57.5 |
| PH103D | Ø 32 | 350 | 59 |

PH104 Material: SUS304 Finish: PSS+BSS

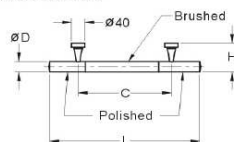

| Item No. | Ø D | L | C | H |
|----------|------|------|------|------|
| PH104A | Ø 32 | 1200 | 1000 | 56 |
| PH104B | Ø 25 | 1500 | 1200 | 52.5 |
| PH104C | Ø 38 | 2000 | 1600 | 59 |
| PH104D | Ø 25 | 400 | 210 | 52.5 |

Free Hinge Series

| Material | Material No. | Finish |
|-----------|--------------|------------------|
| Brass | C3771 | PC, AN, PVD, BSC |
| Aluminium | AL6063 | AL, GD |

PC: Polished Chrome
AN: Antique Nickel
PVD: Polished Zirconium
BSC: Brushed Satin Chrome
AL: Brushed Aluminium Anodizing
GD: Golden Yellow

Maximum Door Weight : 45kg (99 lbs)

Maximum Door Width : 1000mm (39")

For 8mm (5/16") ~ 10mm (3/8") Glass

Patch Lock Series

| Material | Material No. | Cover Finish |
|-----------------|--------------|----------------|
| Stainless Steel | SUS304 | PSS, BSS, PVD |
| | SUS316 | |
| Aluminium | 1050 | AL, CL, DU, DB |
| Brass | C2680 | PB, BSB |

PSS: Polished Stainless Steel
BSS: Brushed Stainless Steel
PVD: Polished Zirconium
AL: Brushed Aluminium Anodizing
GD: Golden Yellow
DU: Duraanodic Aluminium Anodizing
DB: Brushed Duraanodic Aluminium Anodizing
PB: Polished Brass
BSB: Brushed Satin Brass

For 8mm (5/16") ~ 10mm (3/8") Glass

Handle Series

| Material | Material No. | Finish |
|-----------------|--------------|---------------|
| Stainless Steel | SUS304 | PSS, BSS, PVD |

PSS: Polished Stainless Steel
BSS: Brushed Stainless Steel
PVD: Polished Zirconium



PH105 Material: SUS304 Finish: PSS+BN

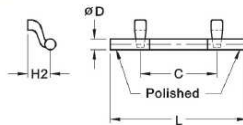

| Item No. | ØD | L | C | H1 | H2 |
|----------|------|------|------|----|----|
| PH105A | Ø 32 | 600 | 400 | 65 | 56 |
| PH105B | | 1000 | 800 | 65 | 56 |
| PH105C | Ø 38 | 1200 | 1000 | 65 | 59 |
| PH105D | | 2000 | 1600 | 65 | 59 |

PH106 Material: Alumium Finish: Anodizing

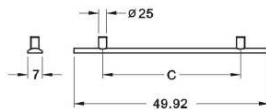

| Item No. | L | C | H |
|----------|------|------|----|
| PH106A | 1000 | 800 | 60 |
| PH106B | 1200 | 1000 | 60 |
| PH106C | 2000 | 1600 | 60 |

PH107 Material: SUS304 Finish: PSS, BN, PVD

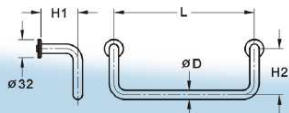

| Item No. | ØD | L | H1 | H2 |
|----------|------|-----|------|-----|
| PH107A | Ø 25 | 250 | 57.5 | 105 |
| PH107B | | 300 | 57.5 | 105 |
| PH107C | | 400 | 57.5 | 105 |
| PH107D | | 500 | 57.5 | 105 |
| PH107E | Ø 32 | 300 | 62.5 | 98 |
| PH107F | | 450 | 62.5 | 98 |
| PH107G | | 600 | 62.5 | 98 |
| PH107H | | 900 | 62.5 | 98 |

PH108 Material: SUS304 Finish: PSS, BN, PVD

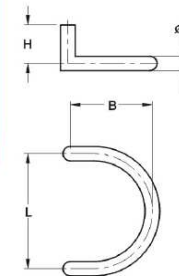

| Item No. | ØD | R | B | H | L |
|----------|------|-----|-----|----|-----|
| PH108A | Ø 25 | 100 | 140 | 75 | 200 |
| PH108B | Ø 32 | 150 | 195 | 85 | 300 |

PH109 Material: SUS304 Finish: PSS, BN, PVD

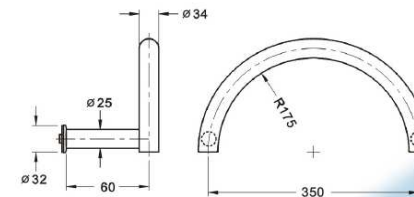

PH110 Material: SUS304 Finish: PSS, BN, PVD

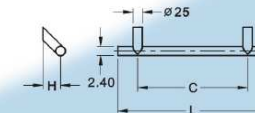

| Item No. | ØD | L | C | H |
|----------|------|------|------|----|
| PH110A | Ø 25 | 1200 | 1000 | 60 |
| PH110B | Ø 25 | 1500 | 1200 | 60 |
| PH110C | Ø 32 | 2000 | 1600 | 60 |

PH111 Material: SUS304 Finish: PSS, BN, PVD

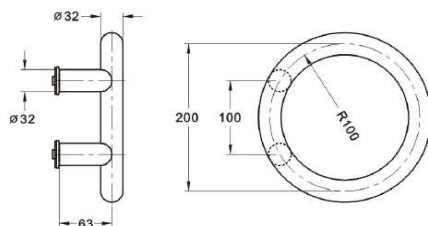

PH112 Material: SUS304+Walnut Finish: PSS or BN

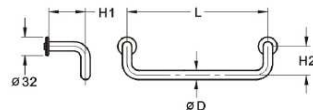

| Item No. | ØD | L | H1 | H2 |
|----------|-----|-----|------|-----|
| PH112A | Ø25 | 300 | 57.5 | 105 |
| PH112B | Ø32 | 305 | 62.5 | 98 |
| PH112C | Ø32 | 600 | 62.5 | 98 |

PH113 Material: C3604 Finish: PC, PB

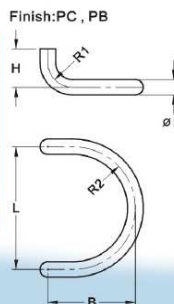

| Item No. | ØD | R1 | R2 | B | H | L |
|----------|-----|----|-----|-----|------|-----|
| PH113A | Ø25 | 40 | 100 | 140 | 57.5 | 200 |
| PH113B | Ø32 | 45 | 150 | 195 | 62.5 | 300 |

PH114 Material: SUS304 Finish: PSS, BN, PVD

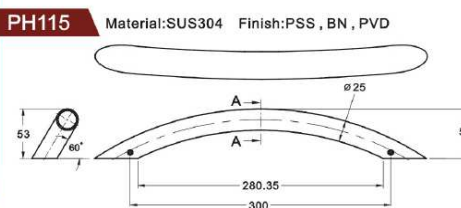
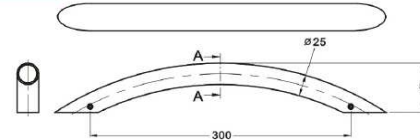

PH115 Material: SUS304 Finish: PSS, BN, PVD

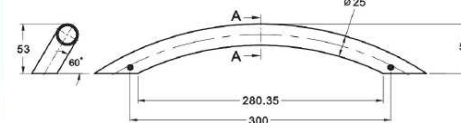
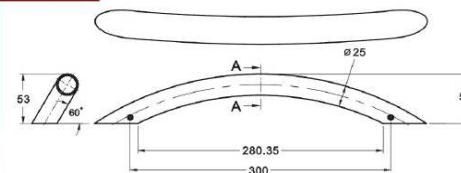

PH116 Material: SUS304 Finish: PSS, BN, PVD

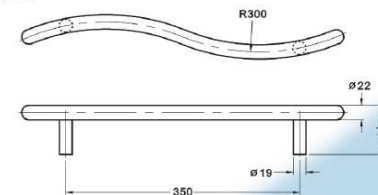

PH117 Material: SUS304 Finish: PSS, BN, PVD

