

BN10
supporto Neuscorre
Neuscorre support

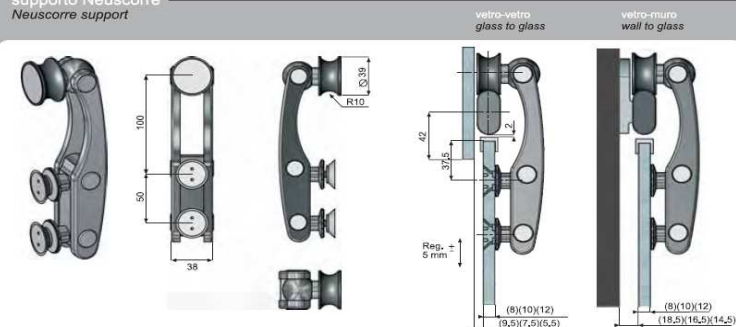

BN20
antiganciamento
release prevention fitting

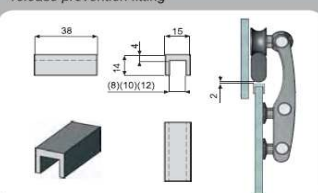

BN30
fermo porta
door stopper

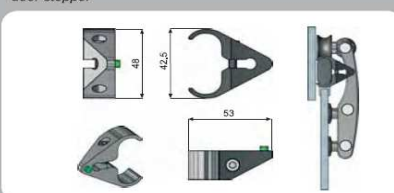

BN40
barra Neuscorre
Neuscorre bar

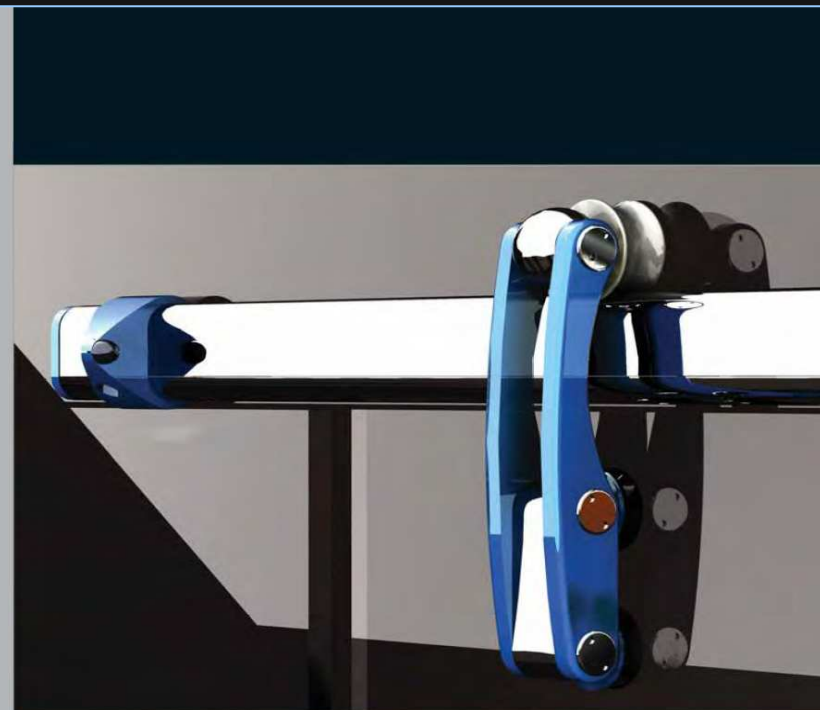
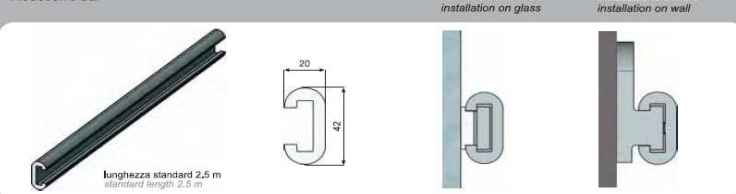

SISTEMA NEUSCORRE
versione rendering dell'applicazione a vetro Arch. Cesare Monti

NEUSCORRE SYSTEM
Rendering version of Arch. Monti's application on glass

BN50
guida a terra
floor guide

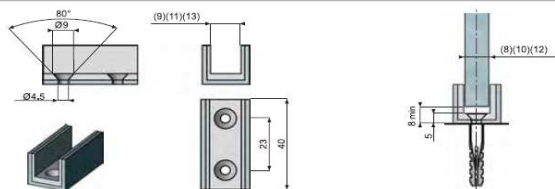

BN60
tappo barra
bar plug

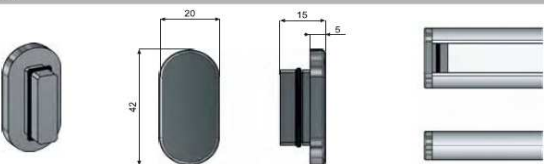

BN70
tassello di fissaggio barra a vetro
fixing dowel for bar on glass

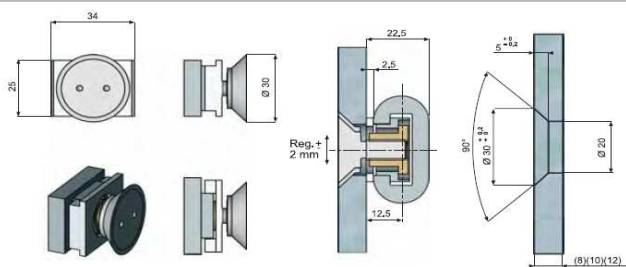

BN80
tassello fissaggio barra a muro
fixing dowel for bar on wall

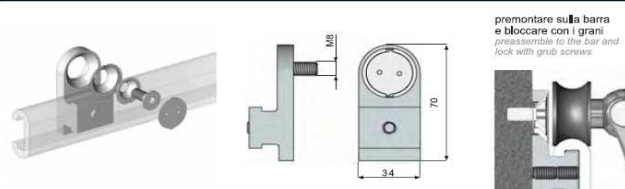

BN90
terminale barra muro
wall bar clamp terminal

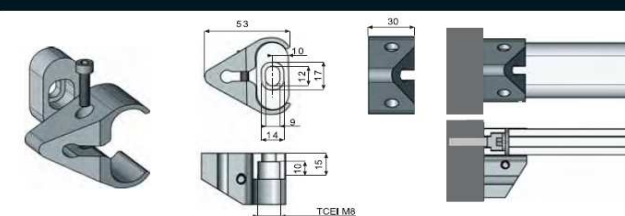

5BN0
maniglione per neuscorre
Neuscorre handle

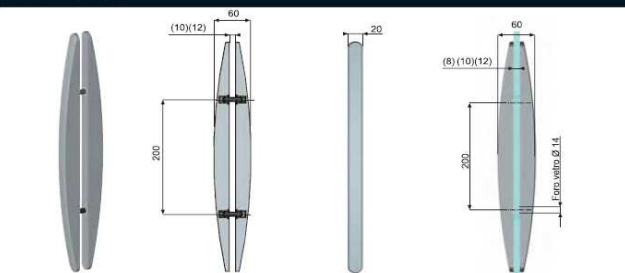

Dati per ricavare le dimensioni della porta L, H e posizione altezza e lunghezza barra Hb, Lb.

Specifications for working out door dimensions L, H, positioning of bar and correct bar length Hb, Lb

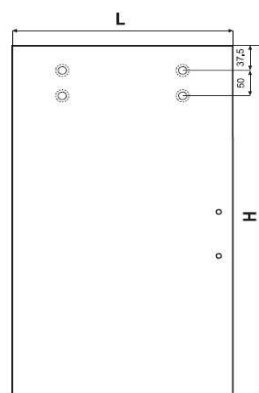

peso massimo della porta = 85kg
maximum door weight 85 kg

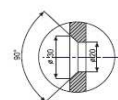

dettaglio foro vetro per alloggiamento vite
detail of hole for screw housing

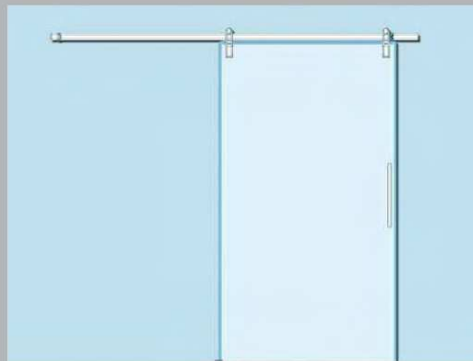
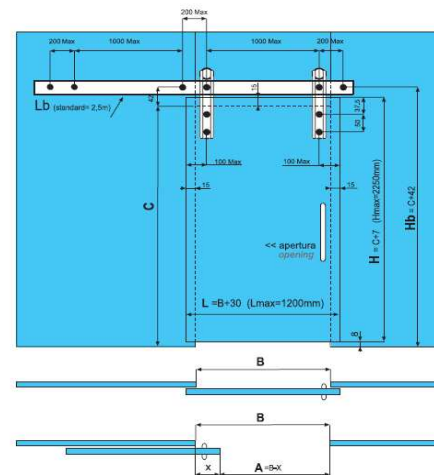
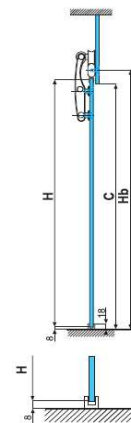
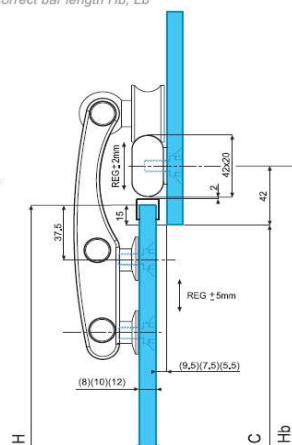

BN00 SET SU VETRO
*BN00 kit for application
on glass*

Componenti set BN00
kit components BN00

Cod. BN10 n° 2
Cod. BN20 n° 2
Cod. BN30 n° 2
Cod. BN40 n° 1
Cod. BN70 n° 6
Cod. BN50 n° 1
Cod. BN60 n° 2
Cod. 5BN0 n° 1

La barra non necessita di forature: il tassello interno può essere posizionato a piacere longitudinalmente e possiede una regolazione verticale di $\pm 2\text{mm}$ per la messa a bolla della barra.

The bar does not need holes: the internal dowel can be positioned lengthwise at your own wish. It can be vertically adjusted of $\pm 2\text{mm}$ for the bar's correct rigging.

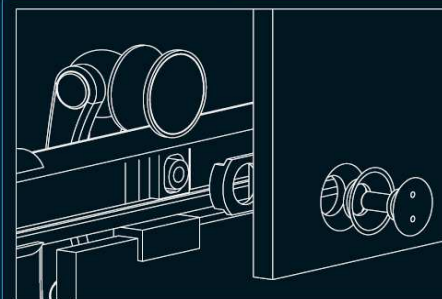

Dati per ricavare le dimensioni della porta L, H e posizione altezza e lunghezza barra Hb, Lb.

Specifications for working out door dimensions L, H, positioning of bar and correct bar length Hb, Lb

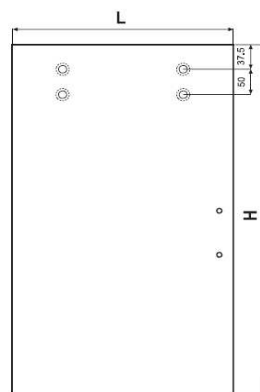

peso massimo della porta = 85kg
maximum door weight 85 kg

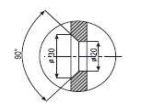

dettaglio foro vetro per alloggiamento vite
detail of hole for screw housing

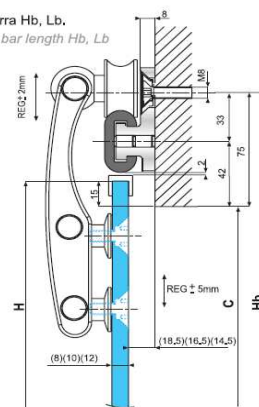

L'applicazione a muro viene effettuata mediante tasselli da commercio (ideali per il tipo di muratura) che possono montare viti SPEI M8.

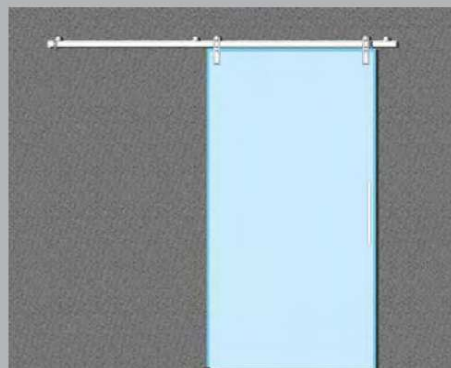
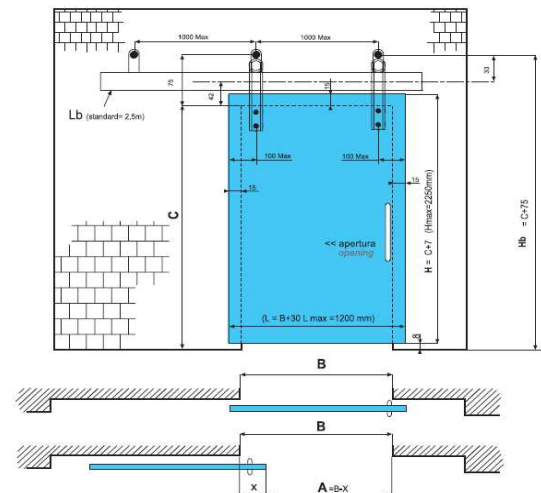

BN05 SET SU MURO
BN05 kit for application on wall

Componenti set BN05
kit components BN05

Cod. BN10 n° 2
Cod. BN20 n° 2
Cod. BN30 n° 2
Cod. BN40 n° 1
Cod. BN80 n° 3
Cod. BN50 n° 1
Cod. BN60 n° 2
Cod. 5BN0 n° 1

SOLUZIONE IN NICCHIA
applications for corners and closets

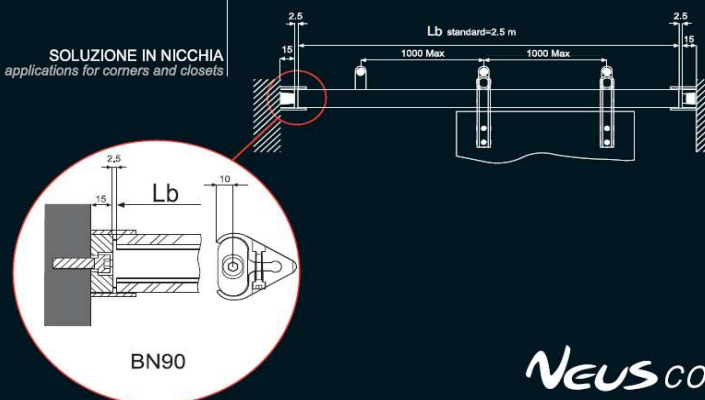

NEUScorre